

DESCRIPTION: **975 SERIES D-SUB BACKSHELL**

**BACKSHELL KIT INCLUDES:**

- (2) BACKSHELL HAVLES
- (2) 4-40 THUMBSCREWS
- (2) HOUSING SCREWS
- (1) STRAIN RELIEF CLAMP
- (2) STRAIN RELIEF SCREWS
- (2) CABLE SLOT SHUT-OFFS(9 POS HAS NONE)

975-YYY-010R011

SERIES \_\_\_\_\_  
 POSITIONS \_\_\_\_\_  
 009 \_\_\_\_\_  
 015 \_\_\_\_\_  
 025 \_\_\_\_\_  
 037 \_\_\_\_\_  
 MATERIAL \_\_\_\_\_  
 010 = PLASTIC \_\_\_\_\_  
 COLOR: \_\_\_\_\_  
 01 = BLACK \_\_\_\_\_  
 PUT-UPS \_\_\_\_\_  
 1 = KIT \_\_\_\_\_

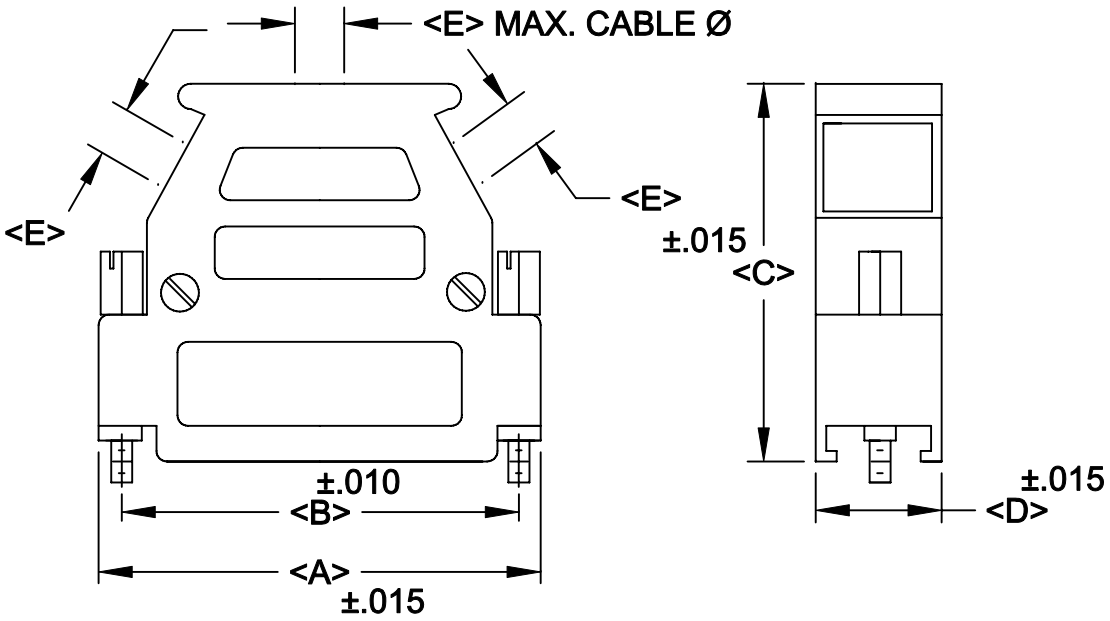

( 9 POS DOES NOT HAVE SIDE ENTRIES)

POS.	A	B	C	D	E
9	1.213	.984	1.800	.600	.300
	30.81	24.99	45.72	15.24	7.62
15	1.541	1.312	1.800	.600	.335
	39.14	33.32	45.72	15.24	8.51
25	2.088	1.852	1.800	.600	.375
	53.04	47.04	45.72	15.24	9.53
37	2.735	2.500	1.800	.600	.400
	69.47	63.50	45.72	15.24	10.16

PLASTIC: ABS POLYLAC U.L. 94V-O  
 THUMBSCREWS: STEEL  
 HOUSING SCREWS: STEEL  
 OPERATING TEMP: -30°C TO +90°C

RoHS COMPLIANT

	THESE DRAWINGS AND SPECIFICATIONS ARE THE PROPERTY OF NorComp AND SHALL NOT BE REPRODUCED, COPIED OR USED AS THE BASIS FOR THE MANUFACTURE OR SALE OF APPARATUS WITHOUT WRITTEN PERMISSION.		DRAWN: <b>PAM JENKINS</b>	DATE: <b>6-10-05</b>
				CHECKED:
<b>NorComp</b>		SCALE	SHEET OF	REV <b>1</b>
		DWG NO. <b>975-YYY-010R011</b>		